



Alarm lamp VIS-LED

MANUAL



Type

Product name:	SENECT® alarm lamp VIS-LED
Type:	VIS-LED
Art.-No.:	3200
Producer:	SENECT GmbH & Co. KG An 44 – Nr. 11 76829 Landau / Germany

Important note:

Please read this manual carefully and store it so that you can use it later. Read the warning and safety notes attentive.

More information and latest software releases or documents can be downloaded from:

www.senect.de

Further information, application descriptions and answers to frequently asked questions can be also found on the SENECT Forum:





<http://forum.senect.de>

© SENECT GmbH & Co. KG - FW 00.80

Table of contents

Type	2
Table of contents.....	3
Used symbols and wording	4
General Security Notes.....	5
Intended use.....	6
Getting started	6
Scope of delivery	6
Note.....	6
Installation and start-up.....	7
Technical data	10
Information about the correct disposal	11
Guarantee.....	11

Used symbols and wording

	<p><i>DANGER!</i></p> <p>Warning of life threatening dangers.</p> <p><i>WARNING!</i></p> <p>Warning of possible life threatening and / or severe irreversible injuries.</p> <p><i>ATTENTION!</i></p> <p>Warning of possible medium or slight injury.</p>
	<p><i>ATTENTION!</i></p> <p>Follow the notes to avoid damage of equipment</p>
	<p><i>NOTE!</i></p> <p>Further information for the use of the device!</p>
	<p><i>ATTENTION!</i></p> <p>Warning of electrical shock.</p>

General Security Notes

The alarm lamp is an electric device designed for visually alarming the user of the SENECT control units in case of a user-defined alarm.



Since it is an electric product the common prerequisites for a safe instrument usage must be fulfilled. Ensure that all cables are installed safely so that no obstacles for persons are built and all. Mount all cables and electric devices protected against direct environmental impacts like overheating by direct sunlight and water. Even if the product is protected against spray water, the product's lifetime will be elongated, if it is mounted on a protected place.

The operating temperature of the device must be between -25°C and +75°C.

The device is designed to be operated by professional users. It can be also operated by children over the age of 8 years and persons with limited physical, sensorial or cognitive ability, if they are supervised, trained in the operation of the device, able to operate the device safely and if they understand potential risks resulting from the operation. It is for children or persons with limited physical, sensorial or

cognitive ability not allowed to perform any maintenance works.

Please store this manual. We suggest the storage a copy of the manual in the vicinity of the device.

Technical and optical changes of this manual are subject to alterations.

Intended use

The alarm lamp is an electric device designed for visually alarming the user of the SENECT control units in case of a user-defined alarm.

The alarm lamp is developed for the use in industrial aquaculture applications.

Getting started

Scope of delivery

- 1 x Alarm lamp VIS-LED
- 1 x Manual

Note



Please check directly after delivery, that the package is not destroyed or damaged or was opened before. Please check also, that all parts as

listed above are included. If anything is missing or broken, please contact us as soon as possible within 14 days. Unfortunately, we cannot accept later information of damage, which happened during the transport.

Installation and start-up



Mount the alarm lamp at a place in the vicinity of your control unit where you can see it best.

To mount the alarm lamp, the upper transparent part of the housing must be opened by rotating this part against the bottom part.

In the bottom part, there are two protection caps inserted which cover the mounting holes (see Fig. 1). Remove these two caps and mount the bottom at the location with 2 screws.

Connect the green plug of the alarm lamp to one of the SENECT controllers actuator output ports („OUT“).

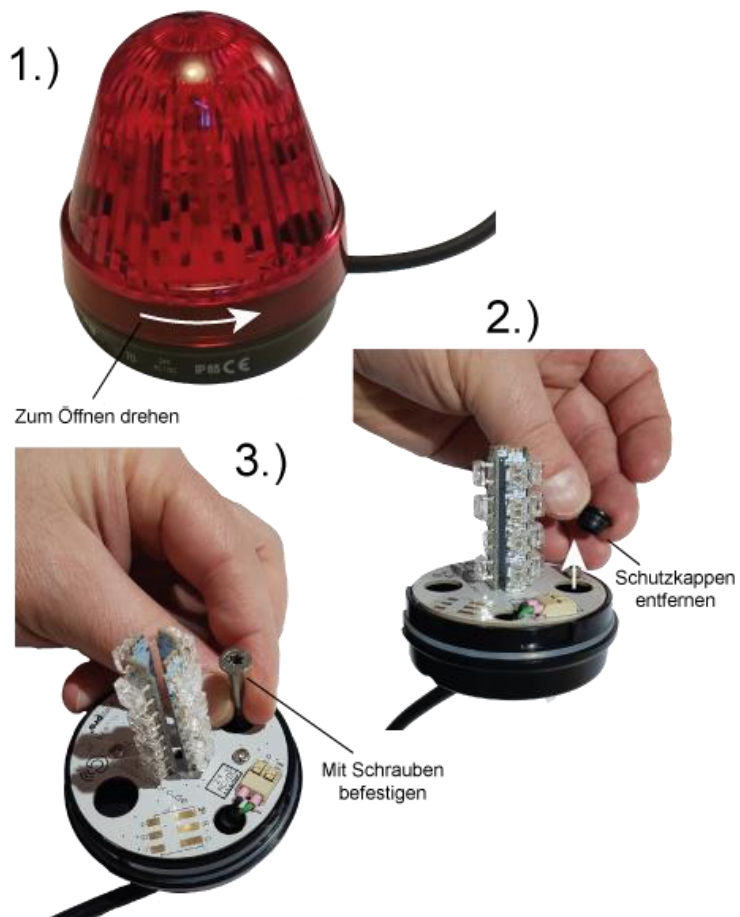

Fig. 1: Mounting the alarm lamp.

Select the function „Alarm“ for this output port in the menu of the controller. Now, the alarm lamp will be switched on in case the controller detects an alarm. You can define the alarm setting at each sensor under „Alarm thresholds“.

Getting started – short version

1. Open housing by rotation.
2. Remove protection caps.
3. Mount the bottom part.
4. Close the housing.
5. Connect cable to controller (actuator plug „OUT“).
6. Select the function „Alarm“ this output port.

Now, the alarm lamp is ready to be used.

Technical data

Dimensions housing:	Ø 61,8 x 62,8 mm
Material:	PC, MPPO
Cable length:	5 m
Voltage:	24 V DC
Power consumption:	1,2 W
Temperature range:	-25°C to +70 °C
Ingress protection:	IP65

Information about the correct disposal



Your device is well packed at delivery. Please dispose the packaging material accordingly to the regulations in your country.

Do not throw the product in the casual litter bin. Make sure you are informed about the local disposal regulations and dispose your product accordingly. Alternatively, you can also send the product back to the producer.

The SENECT GmbH & Co. KG is member of the Stiftung Elektro-Altgeräte Register and the products are registered (WEEE-Reg.-Nr.: DE37193510).

Guarantee



Please check at delivery of your device, that all parts are delivered completely and that they function correctly. In case of any claims, contact us immediately per email or phone (info@senect.de or +49-6341 - 95 95 210). Please describe your claim as detailed as possible so that we can provide a solution as fast as possible. The product has a guarantee of 1 year and a warranty of 2 years. Furthermore, the § 377 HBG (German law) is valid.